

# Section 2

## Non-Threaded Fasteners, Etc.

### TAB WASHERS # 93

Ref: DIN 93 - One Tab

Three materials: Plain Steel, A2 (304) Stainless or A4 (316) Stainless

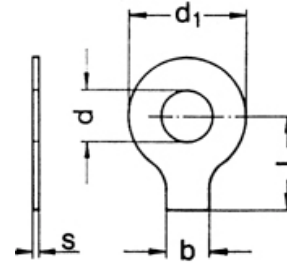

SCREW DIA. mm	# 93 Steel	# 93 A2 Stainless	# 93 A4 Stainless	I.D. mm d	O.D. mm d1	b	l	s
3	x	-	-	3.2	12	4	13	0.38
4	x	x	-	4.3	14	5	14	0.38
5	x	x	x	5.3	17	6	16	0.5
6	x	x	x	6.4	19	7	18	0.5
8	x	x	x	8.4	22	8	20	0.75
10	x	x	x	10.5	26	10	22	0.75
12	x	x	x	13	30	12	28	1
14	x	x	x	15	33	12	28	1
16	x	x	x	17	36	15	32	1
18	x	x	x	19	40	18	36	1
20	x	x	x	21	42	18	36	1
22	x	x	x	23	50	20	42	1
24	x	x	x	25	50	20	42	1
27	x	x	x	28	58	23	48	1.6
30	x	x	x	31	63	26	52	1.6
33	x	-	-	34	68	28	56	1.6
36	x	x	-	37	75	30	60	1.6
39	x	-	-	40	82	32	64	1.6
42	x	-	-	43	88	35	70	1.6

"x" denotes stock availability

### TWO TAB WASHERS # 463

Ref: DIN 463 - Two Tabs

Two materials: Plain Steel or A4 (316) Stainless

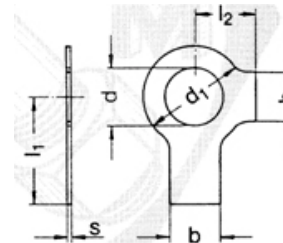

SCREW DIA. mm	# 463 Steel	# 463 A4 Stainless	I.D. mm	O.D. mm	b	l1	l2	S
4	x	-	4.3	9	5	14	6.5	0.38
5	x	x	5.3	10	6	16	8	0.5
6	x	x	6.4	12.5	7	18	9	0.5
8	x	x	8.4	17	8	20	11	0.75
10	x	x	10.5	21	10	22	13	0.75
12	x	x	13	24	12	28	15	1
14	x	x	15	28	12	28	16	1
16	x	x	17	30	15	32	18	1
18	x	x	19	34	18	36	20	1
20	x	x	21	37	18	36	21	1
22	x	x	23	39	20	42	23	1
24	x	x	25	44	20	42	25	1
27	x	x	28	50	23	48	29	1.6
30	x	x	31	56	26	52	32	1.6
33	x	-	34	60	28	56	34	1.6
36	x	-	37	66	30	60	38	1.6
39	x	-	40	72	32	64	41	1.6
42	x	-	43	78	35	70	44	1.6

"x" denotes stock availability

**How to Order**  
 Item #: 93 A2  
 Size: 20  
 Quantity: 300  
 Tel: 1-888-966-MMCC