

Section 1 Threaded Fasteners

TURNBUCKLES # 1480

With Two Weld Studs - Steel - Left Hand/Right Hand - Coarse Thread



NOM. DIA.	6 x 1	8 x 1.25	10 x 1.5	12 x 1.75	14 x 2	16 x 2	20 x 2.5	24 x 3	30 x 3.5	36 x 4
BODY	110	110	125	125	140	170	200	255	255	295
STUD	120	120	150	150	175	200	220	260	260	300
MIN. THREAD	65	65	75	75	85	100	120	150	150	180

U BOLTS # 3570

U Bolt Clamps - Form "A" - Material: ST 37 - Steel - Zinc Plated

Nom. Size = Thread Size x Inside Nominal Diameter

THREAD SIZE	NOM. SIZE	AVAILABILITY	THREAD LENGTH b	OVERALL HEIGHT h	FOR PIPE DIAMETER d
M 10	10 x 30	x	40	70	25 - 26.9
M 10	10 x 38	x	40	76	30 - 33.7
M 10	10 x 46	x	50	86	38 - 42.2
M 10	10 x 52	x	50	92	45 - 48.3
M 12	12 x 64	x	50	109	57 - 60.3
M 12	12 x 82	x	50	125	72 - 76.1
M 12	12 x 94	x	50	138	85 - 88.9
M 16	16 x 120	x	60	171	108 - 114.3
M 16	16 x 148	x	60	191	133 - 139.7
M 16	16 x 176	x	60	217	159 - 168.3
M 16	16 x 202	x	60	249	185 - 194.9

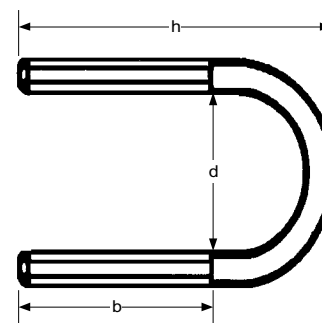

"x" denotes stock availability

HANGER BOLTS FOR WOOD # 88149

Steel - Zinc Plated - One Side = Wood Thread, Other Side = ISO Metric Screw Thread



Nom Size = ISO Metric Thread Diameter x Overall Length

NOM. SIZE	AVAILABILITY	NOM. SIZE	AVAILABILITY	NOM. SIZE	AVAILABILITY
M5 x 40	x	M8 x 50	x	M10 x 60	x
M5 x 50	x	M8 x 60	x	M10 x 80	x
M6 x 50	x	M8 x 70	x	M10 x 100	x
M6 x 60	x	M8 x 80	x	M10 x 120	x
M6 x 70	x	M8 x 100	x	M10 x 130	x
M6 x 80	x	M8 x 120	x	M10 x 140	x
M6 x 100	x	M8 x 140	x	M12 x 80	x
M6 x 120	x	M8 x 150	x	M12 x 100	x
		M8 x 160	x		

"x" denotes stock availability

How to Order

Item #: 1480
Size: 8 x 1.25
Quantity: 25
Tel: 1-888-966-MMCC