

Section 1 Threaded Fasteners

LIFTING RING BOLTS # 580

Ref: DIN 580
Two Materials: C 15 Steel - A2 (304) Stainless

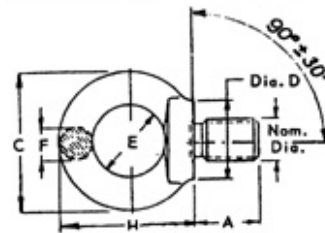

NOM. SIZE (Coarse Thread)	# 580 C 15 STEEL	# 580 A2 304 STAINLESS STEEL	MAX. LOAD*		DATA in mm						WEIGHT lbs.
			1 BOLT lbs.	2 BOLTS lbs.	A	C	D	E	F	H	
6 x 1	x	-	-	-	13	36	20	20	8	36	.11
8 x 1.25	x	x	300	200	13	36	20	20	8	36	.13
10 x 1.5	x	x	500	350	17	45	25	25	10	45	.24
12 x 1.75	x	x	700	500	20.5	54	30	30	12	53	.40
14 x 2	x	-	-	-	27	63	35	35	14	62	.50
16 x 2	x	x	1500	1100	27	63	35	35	14	62	.62
18 x 2.5	x	-	-	-	27	72	40	40	16	71	.80
20 x 2.5	x	x	2600	1800	30	72	40	40	16	71	1
22 x 2.5	x	-	-	-	30	72	40	40	16	71	1.3
24 x 3	x	x	3900	2700	36	90	50	50	20	90	1.6
27 x 3	x	-	-	-	40	98	60	55	22	99	2.5
30 x 3.5	x	-	7900	5700	45	108	65	60	24	109	3.7
36 x 4	x	-	11200	8000	54	126	75	70	28	128	5.8
39 x 4	x	-	-	-	60	134	80	75	30	136	7.5
42 x 4.5	x	-	15400	11000	63	144	85	80	32	147	8.9
48 x 5	x	-	18900	13400	68	166	100	90	38	168	14
56 x 5.5	x	-	25300	18200	78	184	110	100	42	187	19.4
64 x 6	x	-	35,200	24,100	90	206	120	110	48	208	24

*x denotes stock availability

*figures indicate load capacity for C 15 steel ONLY

() sizes should be avoided if possible -- not officially listed in DIN & dimensions may vary.

HEAVY DUTY DROP FORGED LIFTING RING BOLTS # 581

Drop Forged Steel

NOM. SIZE A (Coarse Thread)	THREAD LENGTH T/B	I.D. EYE C	O.D. EYE D =	OVERALL LENGTH ≈	MAX. LOAD (1 Bolt) lbs.
6 x 1	25.4	19	30	56	462
7 x 1	28.5	22	37	68	814
8 x 1.25	31.7	25	43	79	992
10 x 1.5	35	28	46	87	1628
12 x 1.75	38	30	54	97	2266
14 x 2	44.5	35	58	107	3520
16 x 2	44.5	35	65	116	3520
18 x 2.5	51	38	72	130	4708
20 x 2.5	57	43	81	146	6292
24 x 3	63.5	46	91	165	8470
27 x 3	70	51	105	185	11440
30 x 3.5	76	55	115	205	14080
36 x 4	89	63	135	235	19734

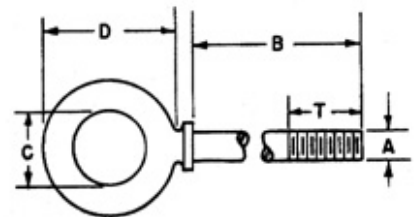

How to Order

Item #: 580

Size: M 24 x 3

Quantity: 12

Tel: 1-888-966-MMCC

All Lifting Ring Bolts must be screwed tight and fit flush against the bearing surface. Any loading at right angles to the plane of the eye is NOT permissible.