

Section 1

Threaded Fasteners



FINE THREAD SOCKET SET SCREWS # 916 - CUP POINT FINE THREAD SOCKET SET SCREWS # 913 - FLAT POINT

Material: 45H Alloy Steel (450 HV min, grade 14.9) - Quenched and Tempered

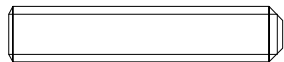

913



916

NOM. SIZE	# 916	# 913
6 x .75 x 6	x	x
6 x .75 x 8	x	x
6 x .75 x 10	x	x
6 x .75 x 12	x	x
6 x .75 x 16	x	x
6 x .75 x 20	x	x
8 x 1 x 8	x	x
8 x 1 x 10	x	x
8 x 1 x 12	x	x
8 x 1 x 16	x	x
8 x 1 x 20	x	x
8 x 1 x 25	x	x
8 x 1 x 30	x	x
10 x 1.25 x 10	x	x
10 x 1.25 x 12	x	x
10 x 1.25 x 16	x	x
10 x 1.25 x 20	x	x
10 x 1.25 x 25	x	x
10 x 1.25 x 30	x	x
10 x 1.25 x 35	x	x
10 x 1.25 x 40	x	x
10 x 1.25 x 45	x	x
10 x 1.25 x 50	-	x
10 x 1 x 10	x	x
10 x 1 x 12	x	x
10 x 1 x 16	x	x
10 x 1 x 20	x	x
10 x 1 x 25	x	x
10 x 1 x 30	x	x
10 x 1 x 35	x	x
10 x 1 x 40	x	x
10 x 1 x 45	x	x
10 x 1 x 50	x	x

NOM. SIZE	# 916	# 913
12 x 1.5 x 12	x	x
12 x 1.5 x 16	x	x
12 x 1.5 x 20	x	x
12 x 1.5 x 25	x	x
12 x 1.5 x 30	x	x
12 x 1.5 x 35	x	x
12 x 1.5 x 40	x	x
12 x 1.5 x 45	x	x
12 x 1.5 x 50	x	x
12 x 1.25 x 12	x	x
12 x 1.25 x 16	x	x
12 x 1.25 x 20	x	x
12 x 1.25 x 25	x	x
12 x 1.25 x 30	x	x
12 x 1.25 x 35	x	x
12 x 1.25 x 40	x	x
12 x 1.25 x 45	x	x
12 x 1.25 x 50	x	x
16 x 1.5 x 16	x	x
16 x 1.5 x 20	x	x
16 x 1.5 x 25	x	x
16 x 1.5 x 30	x	x
16 x 1.5 x 35	x	x
16 x 1.5 x 40	x	x
16 x 1.5 x 45	x	x
16 x 1.5 x 50	x	x
20 x 1.5 x 20	x	x
20 x 1.5 x 25	x	x
20 x 1.5 x 30	x	x
20 x 1.5 x 35	x	x
20 x 1.5 x 40	x	x
20 x 1.5 x 50	x	x
20 x 1.5 x 60	x	x

"x" denotes stock availability

How to Order
 Item #: 916
 Size: 12 x 1.25 x 30
 Quantity: 100
 Tel: 1-888-966-MMCC

For dimensional information, please refer to charts on the following pages: # 916 page 1-56 and # 913 page 1-59.
 Please be aware that Fine Thread Socket Set Screws are made by significantly fewer manufacturers that the regular coarse thread sizes.
 Deliveries on backorders will often exceed 4 weeks.