

Section 1 Threaded Fasteners

BUTTON HEAD, SOCKET HEAD CAP SCREWS # 7380

Ref: ISO 7380 - Coarse Thread Pitch - Fully Threaded
Two Materials: Heat Treated Alloy Steel - Grade 10.9 - Black Tensile Strength: 150,800 psi min.
A2 Stainless (304) passivated Tensile Strength: 100,000 psi min.

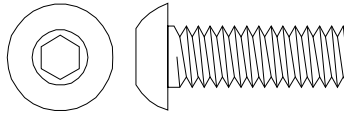

NOM. SIZE	# 7380 10 10.9 Black	# 7380 A2 304 Stainless Steel	NOM. SIZE	# 7380 10 10.9 Black	# 7380 A2 304 Stainless Steel	NOM. SIZE	# 7380 10 10.9 Black	# 7380 A2 304 Stainless Steel
2 x 3	x	x	4 x 16	x	x	8 x 25	x	x
2 x 4	x	x	4 x 20	x	x	8 x 30	x	x
2 x 5	x	x	4 x 25	x	x	8 x 35	x	x
2 x 6	x	x	4 x 30	x	x	8 x 40	x	x
2 x 8	x	x	4 x 35	x	x	8 x 45	x	x
2 x 10	x	x	4 x 40	x	x	8 x 50	x	x
2 x 12	x	x	5 x 6	x	x	8 x 60	x	x
2 x 16	x	x	5 x 8	x	x	8 x 70	x	x
2 x 20	x	-	5 x 10	x	x	8 x 80	x	x
2.4 x 3	x	x	5 x 12	x	x	10 x 12	x	-
2.5 x 4	x	x	5 x 14	x	x	10 x 14	x	-
2.5 x 5	x	x	5 x 16	x	x	10 x 16	x	-
2.5 x 6	x	x	5 x 20	x	x	10 x 20	x	x
2.5 x 8	x	x	5 x 25	x	x	10 x 25	x	x
2.5 x 10	x	x	5 x 30	x	x	10 x 30	x	x
2.5 x 12	x	x	5 x 35	x	x	10 x 35	x	x
2.5 x 14	x	x	5 x 40	x	x	10 x 40	x	x
2.5 x 16	x	x	5 x 45	x	x	10 x 45	x	x
2.5 x 20	x	-	5 x 50	x	x	10 x 50	x	x
3 x 4	x	x	6 x 6	x	-	10 x 60	x	x
3 x 5	x	x	6 x 8	x	x	10 x 70	x	-
3 x 6	x	x	6 x 10	x	x	10 x 80	x	-
3 x 8	x	x	6 x 12	x	x	10 x 90	x	-
3 x 10	x	x	6 x 14	x	x	10 x 100	x	-
3 x 12	x	x	6 x 16	x	x	12 x 16	x	-
3 x 14	x	x	6 x 20	x	x	12 x 20	x	-
3 x 16	x	x	6 x 25	x	x	12 x 25	x	-
3 x 20	x	x	6 x 30	x	x	12 x 30	x	-
3 x 25	x	x	6 x 35	x	x	12 x 35	x	-
3 x 30	x	x	6 x 40	x	x	12 x 40	x	-
3 x 35	x	x	6 x 45	x	x	12 x 45	x	-
3 x 40	x	x	6 x 50	x	-	12 x 50	x	-
4 x 5	x	x	6 x 60	x	-	12 x 60	x	-
4 x 6	x	x	8 x 8	x	-	12 x 70	x	-
4 x 8	x	x	8 x 10	x	x	12 x 80	x	-
4 x 10	x	x	8 x 12	x	x	12 x 90	x	-
4 x 12	x	x	8 x 14	x	x	12 x 100	x	-
4 x 14	x	x	8 x 16	x	x			
			8 x 20	x	x			

"x" denotes stock availability

Data in mm ISO 7380

THREAD SIZE		M 2	M 2.5	M 3	M 4	M 5	M 6	M 8	M 10	M 12	M 16*
a	PITCH	mm	0.4	0.45	0.5	0.7	0.8	1	1.25	1.5	2
	HEAD DIA.	max.	3.5	4.5	5.7	7.6	9.5	10.7	14	17.5	28
h		min.	3.25	4.25	5.4	7.24	9.14	10.5	13.57	17.07	27.48
	HEAD HEIGHT	max.	1.3	1.5	1.65	2.2	2.75	3.3	4.4	5.5	8.8
		min.	1.1	1.24	1.4	1.95	2.5	3	4.1	5.2	8.44
HEX KEY SIZE		nom.	1.3	1.5	2	2.5	3	4	5	6	10

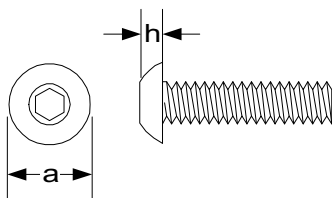

How to Order
Item #: 7380 A2
Size: 6 x 25
Quantity: 200
Tel: 1-888-966-MMCC

M 16 available in production quantities only - **Please inquire.**
A4 (316) Stainless also available - **Please inquire.**