

Section 1 Threaded Fasteners

FINE THREAD SOCKET HEAD CAP SCREWS # 912 12

Ref: DIN 912/ISO 4762

Material: Steel - Property Class: 12.9 - Tensile 1,200 MPa (174,000 psi)

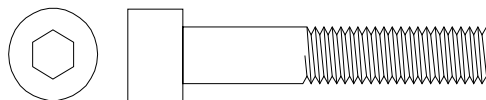

NOM. SIZE	AVAILABILITY	NOM. SIZE	AVAILABILITY	NOM. SIZE	AVAILABILITY
8 x 1 x 12	x	10 x 1.25 x 45	x	14 x 1.5 x 30	x
8 x 1 x 16	x	10 x 1.25 x 50	x	14 x 1.5 x 35	x
8 x 1 x 20	x	10 x 1.25 x 60	x	14 x 1.5 x 40	x
8 x 1 x 25	x	10 x 1.25 x 70	x	14 x 1.5 x 50	x
8 x 1 x 30	x	12 x 1.25 x 20	x	14 x 1.5 x 60	x
8 x 1 x 35	x	12 x 1.25 x 25	x	14 x 1.5 x 70	x
8 x 1 x 40	x	12 x 1.25 x 30	x	14 x 1.5 x 80	x
8 x 1 x 45	x	12 x 1.25 x 35	x	14 x 1.5 x 90	x
8 x 1 x 50	x	12 x 1.25 x 40	x	14 x 1.5 x 100	x
10 x 1 x 16	x	12 x 1.25 x 45	x	16 x 1.5 x 35	x
10 x 1 x 20	x	12 x 1.25 x 50	x	16 x 1.5 x 40	x
10 x 1 x 25	x	12 x 1.25 x 60	x	16 x 1.5 x 45	x
10 x 1 x 30	x	12 x 1.25 x 70	x	16 x 1.5 x 50	x
10 x 1 x 35	x	12 x 1.5 x 20	x	16 x 1.5 x 60	x
10 x 1 x 40	x	12 x 1.5 x 25	x	16 x 1.5 x 70	x
10 x 1 x 45	x	12 x 1.5 x 30	x	16 x 1.5 x 80	x
10 x 1 x 50	x	12 x 1.5 x 35	x	16 x 1.5 x 90	x
10 x 1 x 60	x	12 x 1.5 x 40	x	16 x 1.5 x 100	x
10 x 1 x 70	x	12 x 1.5 x 45	x	20 x 1.5 x 50	x
10 x 1.25 x 16	x	12 x 1.5 x 50	x	20 x 1.5 x 60	x
10 x 1.25 x 20	x	12 x 1.5 x 60	x	20 x 1.5 x 70	x
10 x 1.25 x 25	x	12 x 1.5 x 70	x	20 x 1.5 x 80	x
10 x 1.25 x 30	x			20 x 1.5 x 90	x
10 x 1.25 x 35	x			20 x 1.5 x 100	x
10 x 1.25 x 40	x			20 x 1.5 x 110	x
				20 x 1.5 x 120	x

"x" denotes stock availability

How to Order
 Item #: 912 12
 Size: 12 x 1.25 x 40
 Quantity: 50
 Tel: 1-888-966-MMCC

For other fine thread diameters and longer lengths - **Please inquire.**

Be aware that fine thread socket head screws are made by significantly fewer manufacturers than the regular coarse thread sizes. Deliveries on backorders will often exceed 4 weeks.