

Section 1 Threaded Fasteners

METRIC PARALLEL THREAD SOCKET PIPE PLUGS # 908

Ref: DIN 908

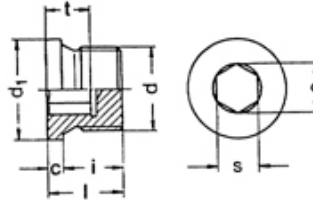

FINE THREAD DIA. x PITCH	DATA mm			HEX KEY S	SEAL RING		TAP DRILL SIZE	TAP	# 908 Steel	# 908 A4 316 Stainless Steel	# 908 BR Brass
	Thread Length i	Flange O.D. d1	Flange Height c		"O" Ring	Copper # 7603 CU					
M 10 x 1	8	14	3	5	10 x 2	10 x 14	9	10 x 1	x	x	x
M 12 x 1.5	12	17	3	6	12 x 2.5	12 x 17	10.5	12 x 1.5	x	x	x
M 14 x 1.5	12	19	3	6	15 x 2.5	14 x 18	12.5	14 x 1.5	x	x	x
M 16 x 1.5	12	21	3	8	17 x 2.5	16 x 20	14.5	16 x 1.5	x	x	x
M 18 x 1.5	12	23	4	8	18 x 2.5	18 x 2	16.5	18 x 1.5	x	x	x
M 20 x 1.5	14	25	4	10	20 x 2.5	20 x 24	18.5	20 x 1.5	x	x	x
M 22 x 1.5	14	27	4	10	22 x 2.5	22 x 27	20.5	22 x 1.5	x	x	x
M 24 x 1.5	14	29	4	12	24 x 3	24 x 29	22.5	24 x 1.5	x	x	x
M 26 x 1.5	16	31	4	12	26 x 3	26 x 31	24.5	26 x 1.5	x	-	-
M 30 x 1.5	16	36	4	17	30 x 3	30 x 36	28.5	30 x 1.5	x	x	x
M 36 x 1.5	16	42	5	19	36 x 3.5	36 x 42	34.5	36 x 1.5	x	-	x
M 38 x 1.5	16	44	5	19	38 x 4	38 x 44	36.5	38 x 1.5	x	-	-
M 42 x 1.5	16	49	5	22	42 x 4	42 x 49	40.5	42 x 1.5	x	-	-
M 45 x 1.5	16	52	5	22	45 x 4	45 x 52	43.5	45 x 1.5	x	-	x
M 48 x 1.5	16	55	5	24	48 x 4	48 x 55	46.5	48 x 1.5	x	-	x

"x" denotes stock availability

BSP PARALLEL SOCKET PIPE PLUGS # 908

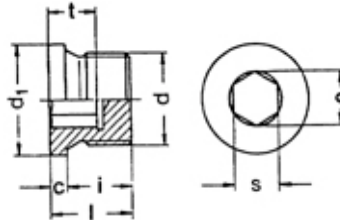

THREAD DIA. x TPI	DATA mm			HEX KEY S	SEAL RING		TAP DRILL SIZE	BSP TAP	# 908 Steel	# 908 A4 316 Stainless Steel	# 908 BR Brass
	Thread Length i	Flange O.D. d1	Flange Height c		"O" Ring	Copper # 7603 CU					
1/8 BSP	8	14	3	5	10 x 2	10 x 14	8.8	1/8 - 28	x	x	x
1/4 BSP	12	18	3	6	13 x 2.5	13 x 18	11.8	1/4 - 19	x	x	x
3/8 BSP	12	22	3	8	17 x 2.5	17 x 22	15.3	3/8 - 19	x	x	x
1/2 BSP	14	26	4	10	20 x 3	21 x 26	19	1/2 - 14	x	x	x
3/4 BSP	16	32	4	12	27 x 2.5	27 x 32	24.5	3/4 - 14	x	x	x
1 BSP	16	39	5	17	32 x 3	33 x 39	30.5	1 - 11	x	x	x
1 1/4 BSP	16	49	5	22	42 x 3.5	42 x 49	39.5	1 1/4 - 11	x	x	x
1 1/2 BSP	16	55	5	24	48 x 3.5	48 x 55	45	1 1/2 - 11	x	x	x
2 BSP	20	68	5	32	60 x 4	60 x 68	57	2 - 11	x	x	x

"x" denotes stock availability

How to Order
 Item #: 908 BR
 Size: 1/2 BSP
 Quantity: 300
 Tel: 1-888-966-MMCC

*Please note: For larger sizes - **Please inquire.**
 For information about the taps listed above, please see Section 5B.