

# Section 1 Threaded Fasteners

## “T”-PRONG NUTS FOR WOOD # 226

Steel - Zinc Plated - 4 Prong Nut

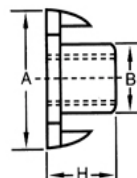

SCREW DIAMETER		M 3 x .5	M 4 x .7	M 5 x .8	M 6 x 1	M 8 x 1.25	M 10 x 1.5	M 12 x 1.75
Flange Dia. mm	A	13	15	17	19	22	25.5	27
Thread Collar mm	B	4.4	5.6	6.5	7.7	10	12	14
Height mm	H	5	6	8	9	11	12	14.5

## KEPS™ TYPE HEX NUTS # 934 TW

Hex Nut with attached serrated lock washers - Material: Steel Class 6/8 - Zinc Plated

SIZE	WASHER O.D.	HEIGHT (min/max)	ACROSS FLATS
M 3 x .5	6.5	2.9 - 3.3	5.5
M 4 x .7	8.2	3.7 - 4.1	7
M 5 x .8	9.5	4.8 - 5.4	8
M 6 x 1	11.5	5.8 - 6.2	10
M 8 x 1.25	15	7.7 - 8.4	13
M 10 x 1.5	19	9.5 - 10.2	17

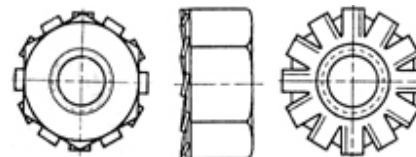

## WING NUTS # 315

Ref: DIN 315

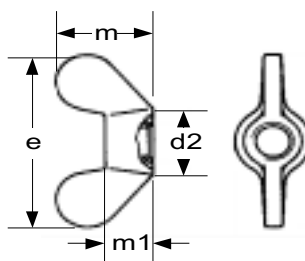

THREAD DIA.	DATA mm*				# 315 Steel Zinc	# 315 A2 304 Stainless Steel	# 315 A4 316 Stainless Steel	# 315 BR Brass	# 315 PL Plastic
	DIA. max.	WIDTH max.	OVERALL	BODY					
M 3 x 0.5	7	18	10	4	x	-	-	-	-
M 4 x 0.7	8	20	10.5	4.6	x	-	x	x	x
M 5 x 0.8	11	26	13	6.5	x	x	x	x	x
M 6 x 1	13	33	17	8	x	x	x	x	x
M 8 x 1.25	16	39	20	10	x	x	x	x	-
M 10 x 1.5	20	51	25	12	x	x	x	x	-
M 12 x 1.75	23	65	33.5	14	x	x	x	x	-
M 16 x 2	29	73	37.5	17	x	x	x	x	-
M 20 x 2.5	35	90	46.5	21	x	-	-	x	-
M 24 x 3	44	110	56.5	25	x	-	-	x	-

\*"x" denotes stock availability

\*Please note: MMCC supplies DIN 315 in both the AT (American Type) and GT (German Type). They differ slightly in the “ear” configuration dimensions but are functionally interchangeable. If you need a specific type for your application - Please inquire.

### How to Order

Item #: 226  
Size: 6 x 1  
Quantity: 500  
Tel: 1-888-966-MMCC

\*\*Please note: For mechanical properties & tolerance information, please refer to Useful Information, Section 10.