

Section 1 Threaded Fasteners

NYLON INSERT LOCK NUTS # 985

Ref: DIN 985/Similar to ISO 7040/ANSI B18.16.3 M

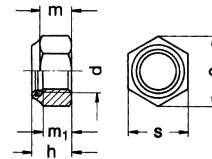

NOMINAL THREAD DIAMETER	PITCH	# 985 Steel Zinc Class 8	# 985 10 Steel Zinc Class 10	# 985 ZY Zinc Yellow Class 8	# 985 A2 304 Stainless Steel	# 985 A4 316 Stainless Steel	# 985 BR Brass	DATA mm		
								Across Flats/Wrench Size s	Overall Height m	Usable Wrench Height m1
M 2.5 x .45~	.45	x	-	-	-	-	-	5	3.5	2
M 3 x .5~	0.5	x	-	x	x	x	x	5.5	4	2.4
M 4 x .7~	0.7	x	-	x	x	x	x	7	5	2.9
M 5 x .8~	0.8	x	x	x	x	x	x	8	5	3.2
M 6 x 1	1	x	x	x	x	x	x	10	6	4
M 7 x 1	1	x	-	-	-	-	-	11	7.5	4.7
M 8 x 1.25	1.25	x	x	x	x	x	x	13	8	5.5
M 8 x 1	1	x	x	-	-	-	-	13	8	5.5
M 10 x 1.5	1.5	x	x	x	x	x	x	17	10	6.5
M 10 x 1.25	1.25	x	x	-	-	-	-	17	10	6.5
M 10 x 1	1	x	x	-	-	-	-	17	10	6.5
M 12 x 1.75	1.75	x	x	x	x	x	-	19	12	8
M 12 x 1.5	1.5	x	x	-	-	-	-	19	12	8
M 12 x 1.25	1.25	x	x	-	-	-	-	19	12	8
M 14 x 2	2	x	x	x	x	x	-	22	14	9.5
M 14 x 1.5	1.5	x	x	-	-	-	-	22	14	9.5
M 16 x 2	2	x	x	x	x	x	-	24	16	10.5
M 16 x 1.5	1.5	x	x	-	-	-	-	24	16	10.5
M 18 x 2.5	2.5	x	x	x	x	x	-	27	18.5	13
M 18 x 1.5	1.5	x	x	-	-	-	-	27	18.5	13
M 20 x 2.5	2.5	x	x	x	x	x	-	30	20	14
M 20 x 1.5	1.5	x	x	-	-	-	-	30	20	14
M 22 x 2.5	2.5	x	x	-	x	x	-	32	22	15
M 24 x 3	3	x	x	-	x	x	-	36	24	15
M 24 x 2	2	x	x	-	-	-	-	36	24	15
M 24 x 1.5	1.5	x	x	-	-	-	-	36	24	15
M 27 x 3	3	x	x	-	x	x	-	41	27	17
M 30 x 3.5	3.5	x	x	-	x	x	-	46	30	19
M 30 x 2	2	x	-	-	-	-	-	46	30	19
M 30 x 1.5	1.5	x	-	-	-	-	-	46	30	19
M 33 x 3.5	3.5	x	x	-	-	-	-	50	33	22
M 36 x 4	4	x	x	-	-	-	-	55	36	25
M 42 x 4.5	4.5	x	-	-	-	-	-	65	42	29
M 48 x 5	5	x	-	-	-	-	-	75	48	36

"x" denotes stock availability

~ Property Class 6/8

HIGH NYLON INSERT LOCK NUTS # 982

Ref: DIN 982/Similar to ISO 7041-2

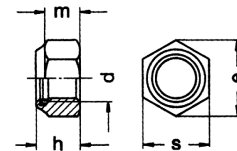

NOMINAL THREAD DIAMETER	PITCH	# 982 Steel Class 8	# 982 10 Steel Class 10	DATA mm		
				Across Flats/Wrench Size s	Overall Height h	Usable Wrench Height m
M 4 x .7	0.7	x	-	7	5.3	3
M 5 x .8	0.8	x	-	8	6.3	4
M 6 x 1	1	x	-	10	8	5
M 8 x 1.25	1.25	x	x	13	9.5	6.5
M 10 x 1.5	1.5	x	x	17	11.5	8
M 12 x 1.75	1.75	x	x	19	14	10
M 12 x 1.5	1.5	x	-	19	14	10
M 14 x 2	2	x	x	22	16	11
M 14 x 1.5	1.5	x	-	22	16	11
M 16 x 2	2	x	x	24	18	13
M 16 x 1.5	1.5	x	-	24	18	13
M 18 x 2.5	2.5	x	x	27	20	15
M 20 x 2.5	2.5	x	x	30	22	16
M 20 x 1.5	1.5	x	-	30	22	16
M 22 x 2.5	2.5	x	-	32	25	17
M 24 x 3	3	x	x	36	28	19

"x" denotes stock availability

How to Order
Item #: 985
Size: 8 x 1.25
Quantity: 500
Tel: 1-888-966-MMCC

**Please note: For mechanical properties & tolerance information, please refer to Useful Information, Section 10.